

Project Name: \_\_\_\_\_  
 Location: \_\_\_\_\_  
 Engineer: \_\_\_\_\_  
 Submitted to: \_\_\_\_\_  
 Submitted by: \_\_\_\_\_  
 Reference: \_\_\_\_\_

Approval: \_\_\_\_\_  
 Date: \_\_\_\_\_  
 Construction: \_\_\_\_\_  
 Unit #: \_\_\_\_\_  
 Drawing #: \_\_\_\_\_

## Performance

*Outdoor Unit Model No:* RXYMQ48PVJU  
*Type:* Non-Ducted  
*Rated Cooling Capacity (Btu/hr):* 48000  
*Nom Cooling Capacity (Btu/hr):* 47500  
*Cooling Input Power (kW):* 4.73  
*SEER:* 15.1  
*IEER:* \_\_\_\_\_  
*Rated Heating Capacity (Btu/hr):* 54000  
*Nom Heating Capacity (Btu/hr):* 52500  
*Heating Input Power (kW):* 4.26  
*Heating COP (Btu/hr / Btu/hr):* 2.6  
*HSPF:* 9.1  
*Heating COP 17F (Btu/hr / Btu/hr):* \_\_\_\_\_

*Condensing Unit Type:* VRV-III-S Heat Pump

*Unit Combination:* \_\_\_\_\_

*Rated Cooling Conditions* Indoor: 80°F DB/67°F WB  
 Outdoor: 95°F DB/75°F WB

*Rated Heating Conditions* Indoor: 70°F DB/60°F WB  
 Outdoor: 47°F DB/43°F WB

*Rated Piping Length (ft)* 25 / 25  
*Rated Height Difference (ft)* 0

## Condensing Unit Details

*Power Supply (V/Hz/Ph):* 208-230/60/1ph  
*Power Supply Connections:* L1, L2, Ground  
*Min. Circuit Amps MCA (A):* 27  
*Max. Overcurrent Protection (MOP)(A):* 30  
*Max. Starting Current MSC(A):* -  
*Rated Load Amps RLA (A):* 23.3  
*Dimensions Height (Inch):* 52-15/16  
*Dimensions Width (Inch):* 35-7/16  
*Dimensions Depth (Inch):* 12-5/8  
*Net Weight (lbs):* 283

*Compressor Type:* Inverter  
*Capacity Control Range (%):* 29 - 100  
*Capacity Index Limit:* 24 - 62.4 (130%)  
*Airflow Rate (CFM):* 3740  
*Gas Pipe Connection (inch):* 5/8  
*Liquid Pipe Connection (inch):* 3/8  
*H/L Pressure Connection (inch):* \_\_\_\_\_  
*H/L Equalizing Connection (inch):* \_\_\_\_\_  
*Sound Pressure Level (dBA):* 58  
*Sound Power Level (dBA):* 69.3c / 68.5h  
*Max. No. of Indoor Units:* 8

## System Details

*Refrigerant Type:* R-410A  
*Holding Refrigerant Charge (lbs):* 8.8  
*Additional Charge (lbs/ft):* install data  
*Pre-charge Piping (Length ft):* -  
*Max. Pipe Length (Total ft):* 492 ft  
*Max. Pipe Length (Vertical ft):* 164 ft / 130 ft  
*Max Height Separation (Ind to Ind ft):* 49 ft

*Cooling Operation Range (°F):* 23 - 115  
*Cooling Range w/Baffle (°F):* \_\_\_\_\_  
*Heating Operation Range (°F):* 0 - 77 / (-4) - 60  
*Heating Range w/Baffle (°F):* \_\_\_\_\_

Project Name: \_\_\_\_\_  
 Location: \_\_\_\_\_  
 Engineer: \_\_\_\_\_  
 Submitted to: \_\_\_\_\_  
 Submitted by: \_\_\_\_\_  
 Reference: \_\_\_\_\_

Approval: \_\_\_\_\_  
 Date: \_\_\_\_\_  
 Construction: \_\_\_\_\_  
 Unit #: \_\_\_\_\_  
 Drawing #: \_\_\_\_\_

**Dimensional Drawing - Condensing Unit**

RXYMQ48PVJU

RXYMQ36/48PVJU  
 Units (in.)

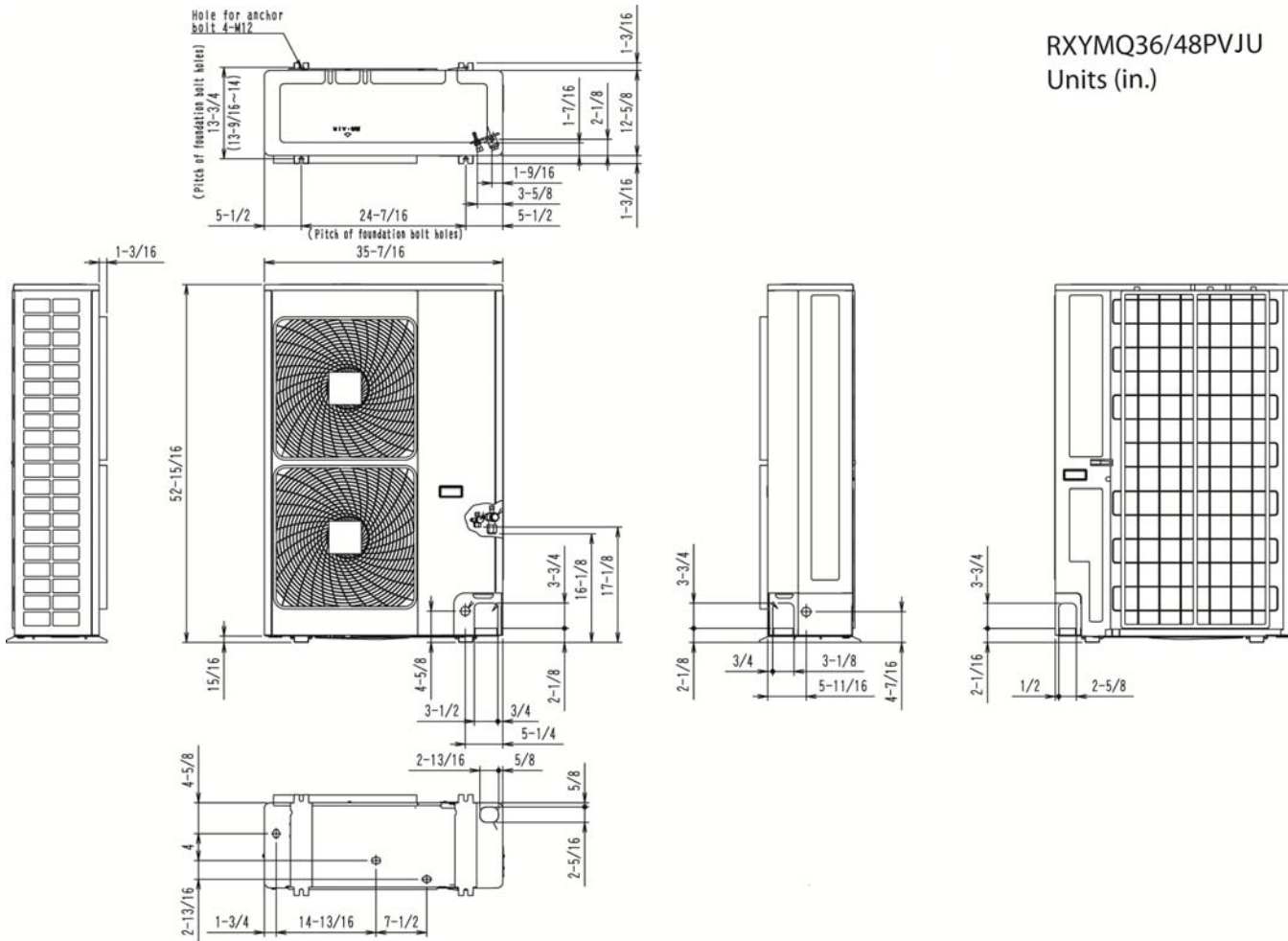

Project Name: \_\_\_\_\_  
Location: \_\_\_\_\_  
Engineer: \_\_\_\_\_  
Submitted to: \_\_\_\_\_  
Submitted by: \_\_\_\_\_  
Reference: \_\_\_\_\_

Approval: \_\_\_\_\_  
Date: \_\_\_\_\_  
Construction: \_\_\_\_\_  
Unit #: \_\_\_\_\_  
Drawing #: \_\_\_\_\_

**RXYMQ48PVJU**



**RXYMQ48PVJU**

Std U.S. Warranty: 7yrs Compressor, 1yrs Parts