

| | |
|-----------|--|
| Job Name: | |
| Tag# | |

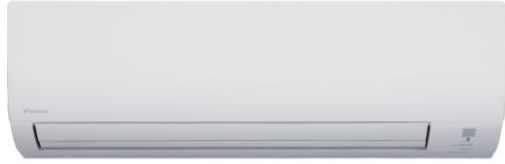

| | |
|--|-------------------------------|
| Submittal Data Sheet | FTX24NMVJU / RX24NMVJU |
| 2-Ton Wall Mounted Heat Pump System | |



| Efficiency | | | |
|------------|------|---------|------|
| Cooling | | Heating | |
| SEER | 18 | HSPF | 9.0 |
| EER | 12.5 | COP | 3.50 |

| Performance | |
|-------------------------------------|---|
| Cooling (Btu/hr) | |
| Rated (Min/Max) | 21,200 (5,500 / 24,000) |
| Sensible @ AHRI | 15,760 |
| Moisture Removal gal/h | 1.2 |
| Operating Range | 50°F – 115°F |
| Rated Cooling Conditions: | |
| | Indoor: 80°F DB/67°F WB Outdoor: 95°F DB/75°F WB |
| Heating (Btu/hr) | |
| 1: @ 47° Rated (Min/Max) | 24,000 (5,800 / 27,600) |
| 2: @ 17° Rated | 14,400 |
| 3: @ 5° Max | 10,720 |
| Operating Range | 5°F – 65°F |
| 1: Rated Heating Conditions: | |
| | Indoor: 70°F DB/60°F WB Outdoor: 47°F DB/43°F WB |
| 2: Rated Heating Conditions: | |
| | Indoor: 70°F DB/60°F WB Outdoor: 17°F DB/15°F WB |
| 3: Rated Heating Conditions: | |
| | Indoor: 70°F DB/60°F WB Outdoor: 5°F DB/5°F WB |

Complete warranty details available from your local dealer or at www.daikincomfort.com. To receive the 12-Year Parts Limited Warranty, online registration must be completed within 60 days of installation. Online registration is not required in California or Quebec. *If product is installed in a commercial application, limited warranty period is 5 years.*

| Indoor Specifications | | | | |
|-------------------------------|----------------------|-----|-------------------|-----|
| | Cooling | | Heating | |
| | H | M | H | M |
| | Airflow Rate (cfm) | 713 | 579 | 745 |
| | L | SL | L | SL |
| | 512 | 403 | 470 | 420 |
| Sound (dBA) H / M / L / SL | 53 / 45 / 39 / 34 | | 53 / 43 / 37 / 34 | |
| Dimensions (H × W × D) (in) | 11-5/8 × 39 × 10-3/8 | | | |
| Weight (Lbs) | 27 | | | |

| Outdoor Specifications | | | | |
|-----------------------------|--------------------------------|-------|---------|-------|
| Compressor | Hermetically Sealed Swing Type | | | |
| Refrigerant | R-410A | | | |
| Refrigerant Oil | PVE (FVC50K) | | | |
| Airflow Rate (cfm) | Cooling | | Heating | |
| | H | 2,101 | H | 1,893 |
| | SL | 1,762 | SL | 1,585 |
| Sound Power Level (dBA) | 55 | | | |
| Dimensions (H × W × D) (in) | 28-5/16 × 34-1/4 × 12-5/8 | | | |
| Weight (Lbs) | 108 | | | |

| Electrical | | |
|---|----------|----------|
| | 208/60/1 | 230/60/1 |
| System MCA | 18.3 | 18.3 |
| System MFA | 20 | 20 |
| Compressor RLA | 12.0 | 12.0 |
| Outdoor fan motor FLA | .38 | .38 |
| Outdoor fan motor W | 58 | 58 |
| Indoor fan motor FLA | .30 | .30 |
| Indoor fan motor W | 46 | 46 |
| MFA: Max. fuse amps MCA: Min. circuit amps (A) FLA: Full load amps (A) | | |
| RLA: Rated load amps (A) W: Fan motor rated output (W) | | |

| Piping | |
|--|--------|
| Liquid (in) | 1/4 |
| Gas (in) | 5/8 |
| Drain (in) | 5/8 |
| Max. Interunit Piping Length (ft) | 98.4 |
| Max. Interunit Height Difference (ft) | 65.625 |
| Chargeless (ft) | 32.8 |
| Additional Charge of Refrigerant (oz/ft) | .21 |

Daikin North America LLC 5151 San Felipe, Suite 500 Houston, TX 77056

(Daikin's products are subject to continuous improvements. Daikin reserves the right to modify product design, specifications and information in this data sheet without notice and without incurring any obligations)

FTX24NMVJU Dimensional Data

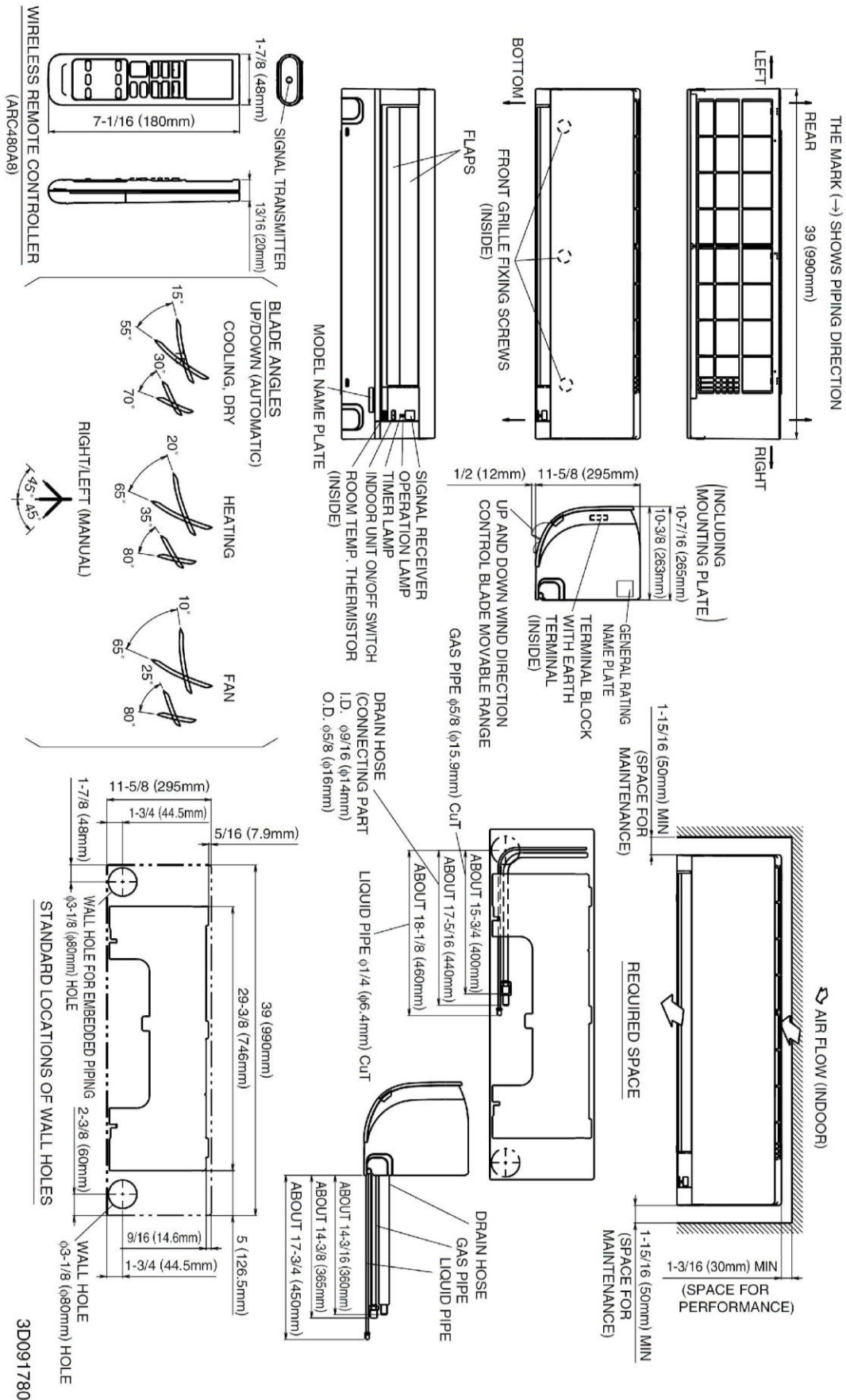

Daikin North America LLC 5151 San Felipe, Suite 500 Houston, TX 77056

(Daikin's products are subject to continuous improvements. Daikin reserves the right to modify product design, specifications and information in this data sheet without notice and without incurring any obligations)

RX24NMVJU Dimensional Data

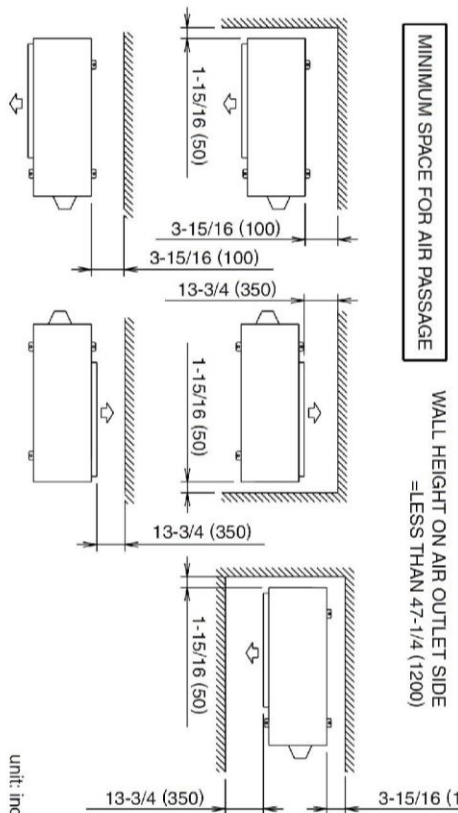
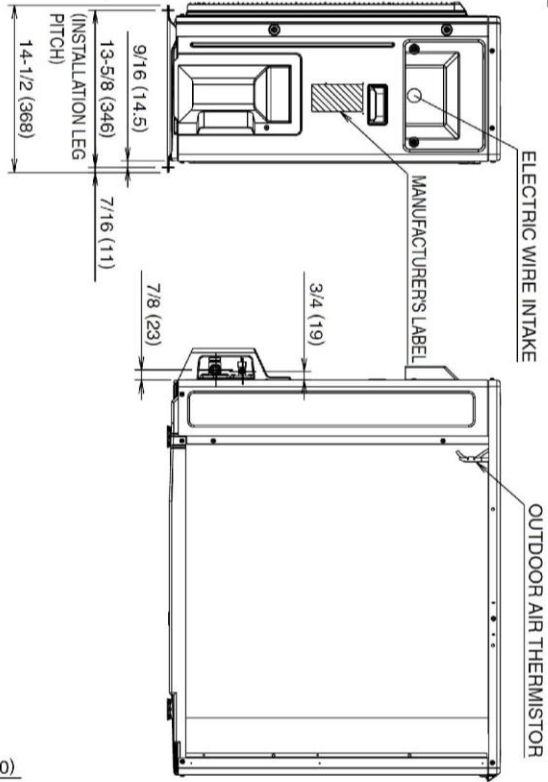
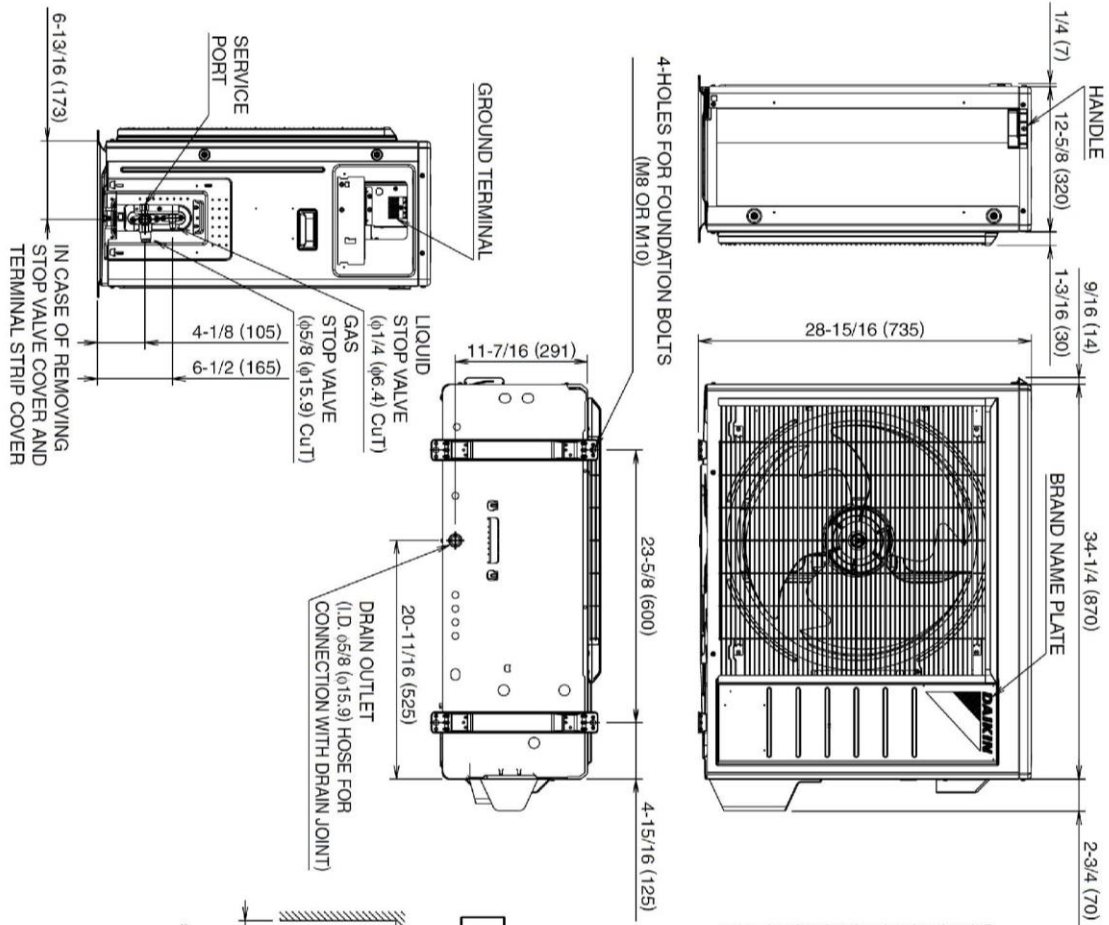

unit: inch (mm)
C: 3D092230

Daikin North America LLC 5151 San Felipe, Suite 500 Houston, TX 77056

(Daikin's products are subject to continuous improvements. Daikin reserves the right to modify product design, specifications and information in this data sheet without notice and without incurring any obligations)

| Indoor Unit | | |
|-------------|-----------------------|--|
| Included | Part Number | Description |
| | BRP072A43 | Wireless Interface Adapter (S21 Adapter Included) |
| | DACA-TS1-1 | Daikin ENVi Intelligent Thermostat Kit (Adaptor Required) |
| | BRC944B2-A08 | Wired Remote Controller kit (Adaptor Required) |
| | BRCW901A08 | Wired Remote Controller Cord - 8m (Included in above kit) |
| | DACA-BRCW901P10 | Remote Controller Cable, Plenum Rated, 10 ft |
| | DACA-BRCW901P25 | Remote Controller Cable, Plenum Rated, 25 ft |
| | KRP980B2 | Adaptor for wired remote controller (18 & 24) |
| | KAF970A45 | Titanium apatite photocatalytic air-purifying filter WITH frame |
| | KAF970A46 | Titanium apatite photocatalytic air-purifying filter WITHOUT frame |
| | DACA-CP1-1 | Inline Condensate Pump (Fits inside all Daikin wall & floor mount units) |
| | DACA-CP4-1 | External Condensate Pump |
| | KRP928BB2S + KRP980B2 | Interface adaptor for DIII-NET |

| Outdoor Unit | | |
|--------------|-------------|--|
| Included | Part Number | Description |
| | DACA-WB-1 | Powder-Coated Wall-Mounted Bracket |
| | KPW063A4 | Air direction adjustment grille (18 & 24) |
| | KEH063A4E | Daikin BML Drain Pan Heater Large RX18,24 & RXN18,24 |
| | KKG063A42 | Back protection wire net (18 & 24) |
| | KKG063A43 | Side protection wire net (18 & 24) |
| | KKP937A4 | Drain Plug for OD Unit |