

AG-1200+

Float Switch System for Metal and Plastic Secondary Pans

The AG-1200+ has all of the features of the 1100+ plus an innovative two-piece clamp design which allows it to be mounted to a metal drain pan (without a lip) or inferior, non-AquaGuard plastic drain pan (with a lip) in 10 seconds or less, without the need for a drain hole in the pan.

Key Features

- 5 amp high-capacity sensor designed for metal and plastic pans
- The industry leading float switch for metal and plastic drain pans
- Easy, no-drill installation
- Protective housing keeps out insulation and debris
- NEW Open circuit wiring option



Product Specs

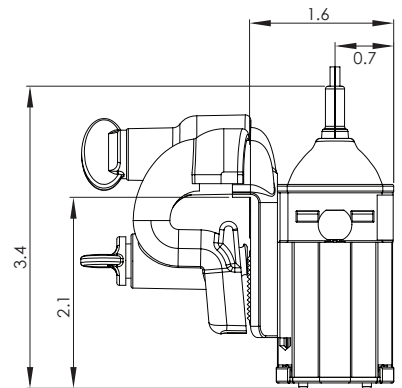
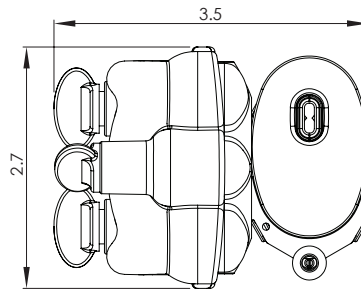
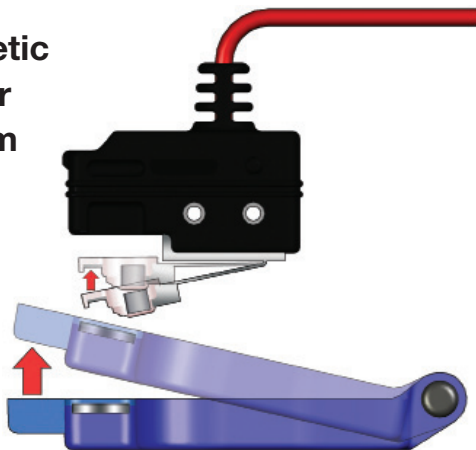

- UL LISTED (UL 508)
- NORMALLY CLOSED OR NORMALLY OPEN
- VERTICAL TRIGGER DEPTH OF 3/4 INCH
- VOLTAGE RATING: 24VAC, 5.0A

Magnetic Trigger System



DRAIN PAN SELECTION CHART

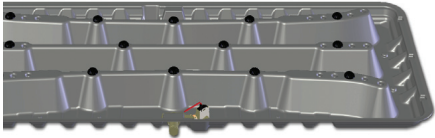
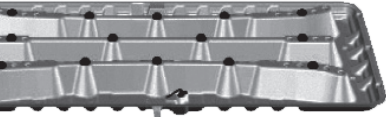
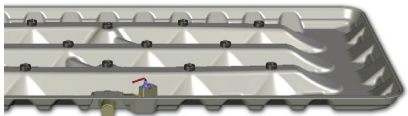
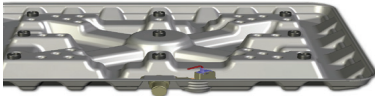
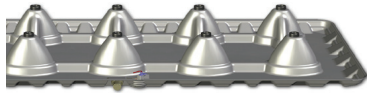
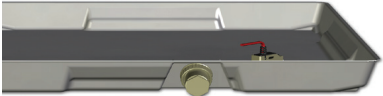

Secondary Pan Model	Pan Size	External Pan Size			Max Unit Size		Recommended Application
Goliath Series							
	30x50	<u>Width</u> 30.25"	<u>Length</u> 50.50"	<u>Height</u> 4.00"	<u>Width</u> 27.25"	<u>Length</u> 47.50"	<i>Hangable When additional clearance is needed under air handler for drain. General Purpose for both furnace and air handler installation.</i>
	30x62	30.38"	63.00"	4.25"	27.38"	60.00"	
	28x57	28.38"	57.25"	5.25"	25.38"	54.25"	
	28x69	28.25"	69.13"	4.25"	26.00"	66.50"	
	30x66	30.25"	66.50"	4.00"	27.25"	64.00"	
Goliath Value Series							
	30x50	<u>Width</u> 30.25"	<u>Length</u> 50.50"	<u>Height</u> 4.00"	<u>Width</u> 27.25"	<u>Length</u> 47.5"	<i>Non-Hangable General purpose for air handler installation.</i>
	30x62	30.38"	63.00"	4.25"	27.38"	60.00"	
	30x66	30.25"	66.50"	4.00"	27.25"	64.00"	
Goliath Low Profile							
	26x56	<u>Width</u> 26.50"	<u>Length</u> 56.63"	<u>Height</u> 2.75"	<u>Width</u> 23.50"	<u>Length</u> 53.63"	<i>Hangable When space is at a minimum in a garage or attic.</i>
Goliath Furnace Series							
	30x36	<u>Width</u> 30.50"	<u>Length</u> 37.50"	<u>Height</u> 3.00"	<u>Width</u> 27.50"	<u>Length</u> 34.50"	<i>Non-Hangable For Vertical, upflow installation of furnace or air handler.</i>
Goliath Furnace Series							
	34x64	<u>Width</u> 34.13"	<u>Length</u> 64.13"	<u>Height</u> 7.50"	<u>Width</u> 31.13"	<u>Length</u> 61.13"	<i>Non-Hangable When greater clearance height is needed to accommodate piping under furnace.</i>
	34x79	33.75"	79.00"	7.50"	30.75"	76.00"	
Titan Flexible Series							
	24x24	<u>Width</u> 24.00"	<u>Length</u> 24.00"	<u>Height</u> 2.25"	<u>Width</u> 20.00"	<u>Length</u> 20.50"	<i>Non-Hangable Flexible and durable enough to bend and fit into tight spaces.</i>
	26x26	26.00"	26.00"	2.25"	22.00"	22.50"	
	30x30	30.00"	30.00"	2.25"	26.00"	26.50"	
	32x32	32.00"	32.00"	2.25"	28.00"	28.50"	
Titan Flexible Series							
	30x50	<u>Width</u> 30.25"	<u>Length</u> 50.50"	<u>Height</u> 2.50"	<u>Width</u> 27.25"	<u>Length</u> 47.50"	<i>Hangable Flexible and durable enough to bend and fit into tight spaces.</i>
	30x62	30.38"	63.00"	2.50"	27.38"	60.00"	

